

The ASEPCO Radial-Diaphragm™ Insulate Valve

ASEPCO

High Purity Valves and
Magnetic Mixers

Designed for Critical Aseptic Processing Applications

ASEPCO radial-diaphragm valves are specifically designed for applications where leakage, dead legs, or cross-contamination are unacceptable. ASEPCO valves provide added security in all high-purity processing.

Features

Extended body and diaphragm allows for direct welding of vessel jacket

Radial-diaphragm

Flush mount design

Self-draining, cleanable

Simple clamp assembly

Change diaphragms in seconds

Integral travel stops

Weep hole under diaphragm

Patented shoulder seal

Behind the seat flow path

Multiple ports, locations, and configurations available

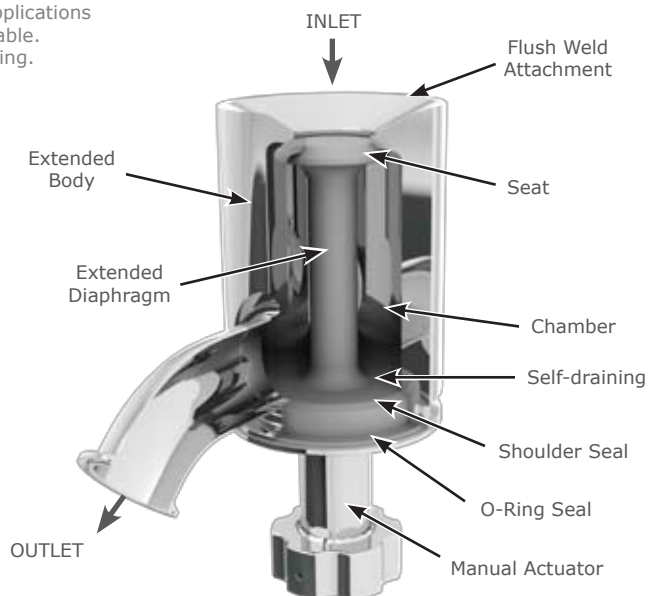

Specifications

Valves

Material	316L, AL6XN, Hastelloy Machined from solid, hot-rolled, bar stock
Surface Finish	Max 20 micro-inch Ra (0.5 µm Ra), Electropolished Max 15 micro-inch Ra (0.375 µm Ra), Electropolished Max 10 micro-inch Ra (0.25 µm Ra), Electropolished
Sizes	1.5 inch, 2 inches
Outlet Connections	Standard: Hygienic clamp, tube end, (others available)
Maximum Pressure	250 psi
Maximum Temperature	135°C/275°F
Marking	Each valve is serialized and marked for full material traceability
ISO	All product and procedures are governed by our ISO Quality Assurance Program
Standards	BPE, CE-PED, ASME

Actuators

Types	Manual or compact pneumatic Fail open or closed
Material	304 stainless steel housing, can be made in 316L
Sizes	1.5 inch, 2 inches
Operating Air Pressure	100psi max for Pneumatic Actuators
Seals	Teflon bushings and o-rings
Fitting	1/8" NPT air connection (for pneumatic)
Possible Instrumentation	Switched With or without solenoids With or without DeviceNet cards

Diaphragms

Materials	Silicone	Silicone Plus	EPDM	EPDM Plus
Temperature Range	-60 to 275°F	-60 to 275°F	-30 to 275°F	-30 to 275°F
Class	USP Class VI, 21 CFR 177.2600	USP Class VI, 21 CFR 177.2600	USP Class VI, 21 CFR 177.2600	USP Class VI, 21 CFR 177.2600
Parylene Treatment	-	✓	-	✓

Please contact our Customer Service Department for any non-standard valve requirement (800) 882-3886.

Insulate Valve Dimensions, Flow Rates, and Weights Specifications

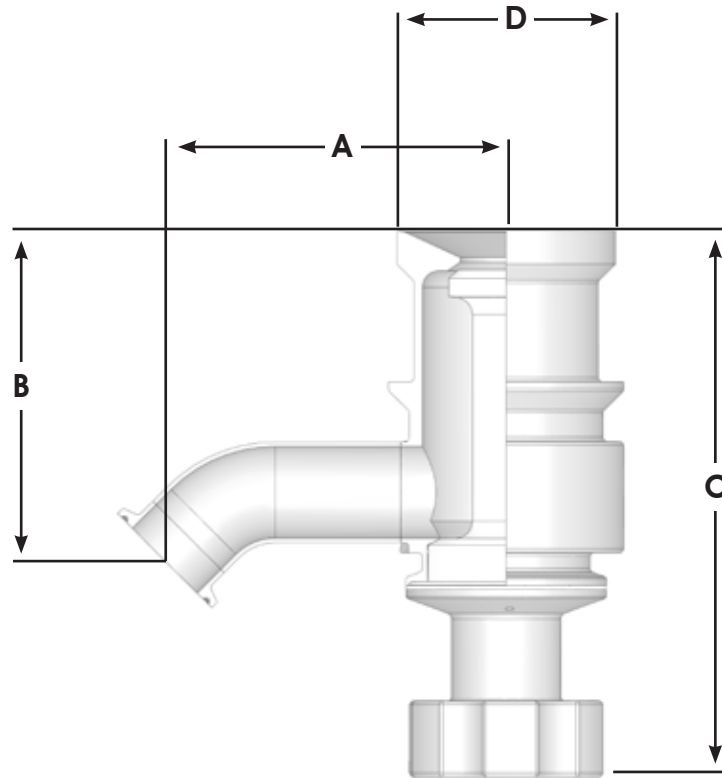

TEXX-100-X: Insulate Valve

Size	A	B	C - with Manual Actuator	C - with Pneumatic Actuator	D
inches	in (mm)	in (mm)	in (mm)	in (mm)	in (mm)
1.50	5.09 (129.3)	4.91 (124.7)	8.14 (206.8)	9.71 (246.6)	3.25 (82.6)
2.00	6.36 (161.5)	6.22 (158.0)	10.58 (268.7)	11.40 (289.6)	4.71 (119.6)

Dimensions are in inches (mm).

Tank Valve Flow Rates

Size	Cv at 1 psi (0.07 bar)
inches	GPM (LPM)
1.50	48 (180)
2.00	72 (272)

Weights

Size	Valve Body	Total Weight with Manual Actuator	Total Weight with Pneumatic Actuator
inches	lb (Kg)	lb (Kg)	lb (Kg)
1.50	4.65 (2.1)	11.70 (5.3)	13.5 (6.1)
2.00	15.75 (7.2)	23.10 (10.5)	24.90 (11.3)